



ES Manufacturing, Incorporated

Est. 1973 **Engineered Solutions**

Makers of fine tools and accessories for the fiberglass and composite industries

2647 24th Street North, Saint Petersburg, Florida USA

Distributed Worldwide 

G960-2.5 w/2 liter High Pressure Spray Gun

Pistola de alta Presión (G9602L2.5)

Includes:

- 1 G960 Spray Gun w/ 2.5mm Nozzle
- 1 PT20 2 Liter Pressure Tank
- 1 AH15 Orange Air Hose 1.5m
- 1 MH15 Black Material Hose 1.5mm
- 1 PT20-012 Plated Steel Handle w/Nut
- 1 PT20-005 Tank Lid Seal (EP)
- 1 Tool Kit, (Stamped Wrench & Hex Key)

Safety Warnings & Precautions:

1. Keep work area clean.
2. Keep children away from this equipment and your work area.
3. Do not operate this equipment under the influence of alcohol or drugs.
4. Do not operate this equipment near open flames or other heat sources.
5. Read all safety information for material to be sprayed.
6. Read all safety information for cleaning materials to be used.
7. Check all seals before connecting to air supply. Make sure lid is fully attached to the cup, retaining is screwed past the first thread, air pressure plug is fully tightened and air supply is sealed and firmly attached.
8. Use eye protection at all times.
9. Wear properly fitting protective clothing at all times.
10. Replace any component that looks worn or damaged immediately.
11. Use only approved ES Manufacturing components.
12. Follow all company safety policies, and contact your supervisor with any questions.

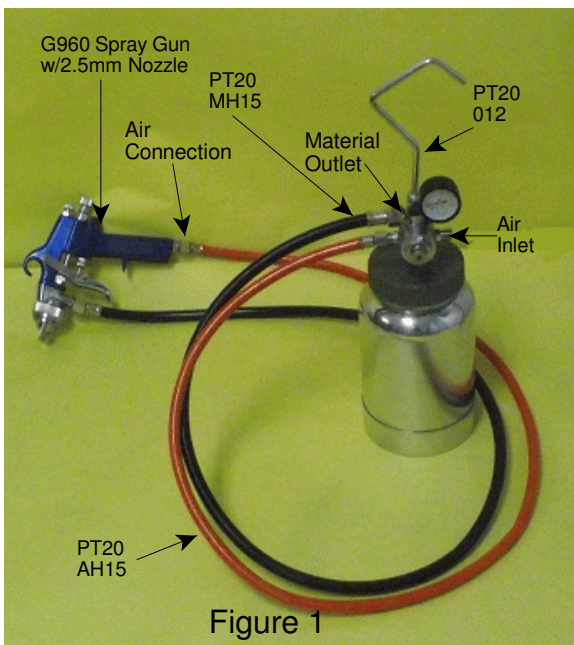

Assembly

Reference Figure 1

1. Connect black material hose (PT20-MH15) to the material outlet as shown, using the supplied wrench.
2. Connect the other end of the black hose to the both of the G960 spray gun head, just below the air cap, using the supplied wrench.
3. Connect the orange air hose (PT20-AH15) to the air connection point on the regulator assembly as shown.
4. Connect the other end of the orange hose to the bottom of the G960 spray gun, at the bottom of the handle as shown. Using teflon sealing tape on these connection will reduce the chance for air leaks.

Assembly

Reference Figure 2

1. Connect plated steel handle (PT20-012) to the top of the centerpost assemble as seen is Figure 1.
2. Lock the supplied plated steel hex nut (PT20-013) to secure steel handle
3. Close the air adjustment cap on the regulator assembly by turning it clockwise.
4. Connect the air hose from your compressor to the air connection point using a 1/4" NPT coupling and a minimum 3/8" hose barb. It is not recommended to use "quick-connect" style fittings, as they will restrict air flow to the tank & gun.
5. Regulate air source to approximately 50 P.S.I.

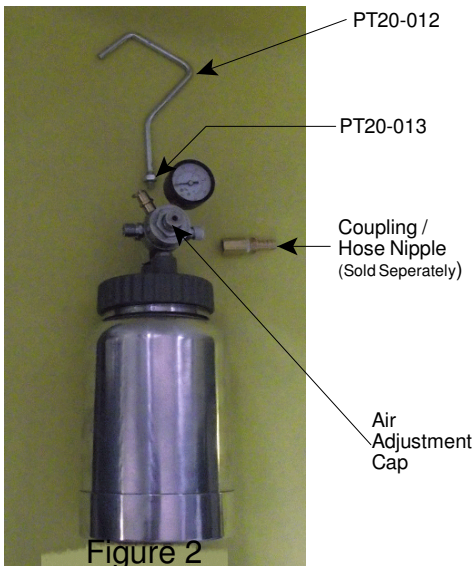

Operation

Reference Figure 3

1. Unscrew and remove tank cover assembly from the aluminum cup.
2. Premix gel coat or resin in cup per manufacturers instructions. Bag liner is optional.
3. Close the air adjustment cap on the regulator assembly by turning it clockwise.
4. Fill cup to 3/4 full mark shown in Figure 4.
5. Lower and assemble tank cover to aluminum cup.
6. Set compressors regulator to the correct setting.
7. Connect the regulators iar connection to the your air source hose. Inspect for leaks and re-seal if neccessary.

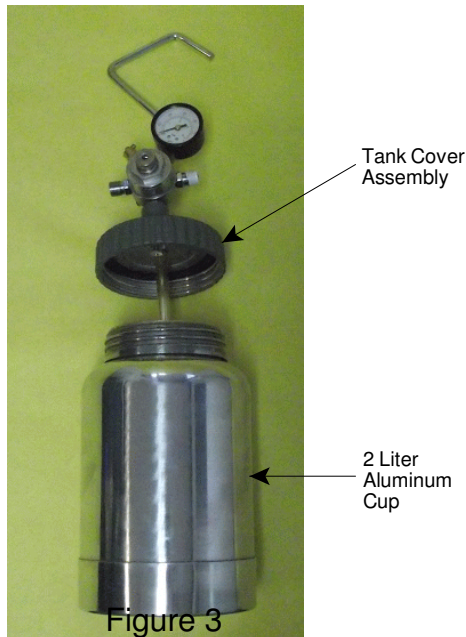

Caution:

When the cup contains material, always keep the spray gun upright. This will keep material from conaminating portions of the spray gun it was not intended to go. Never leave catalyzed gel coat or resin to remain in the aluminum cup.

Caution:

For thorough cleaning, the cup may be fully immerseed in solvent. Do not leave the cup in solvent for more than 24 hours. Never immerse your spray gun in solvent. When cleaning, only brush solvent onto exterior parts only.

Spraying Techniques

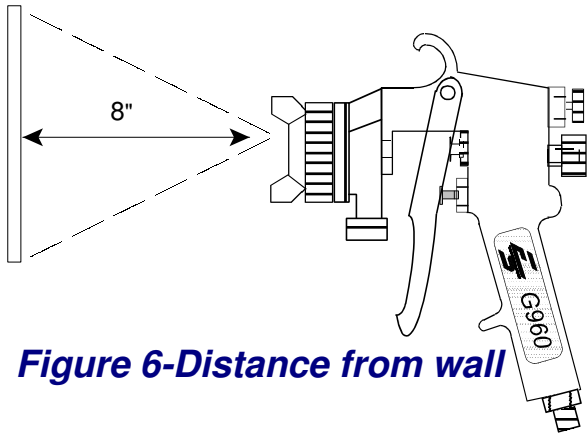

Figure 6-Distance from wall

For Most uses, e.g. painting walls benches. Vehicles. Etc., the best results are obtained by spraying thin, even coats of paint. Let the layers dry in between coats.

As with any manual process, practice leads to perfection. The following are a few general rules that may be of help in perfecting your process:

- * Use the lowest pressure setting recommended by the paint manufacturer.
- * Keep the gun perpendicular.
- * Maintain a distance of about 8" from the work as shown in Figure 6.
- * Make smooth, thin and even strokes across the work. Overlap each stroke by about 50%. (See Figure 7)
- * Let each coat dry before re-coating.

Caution:

Always keep the Cove (g960001) tight when connected to air source

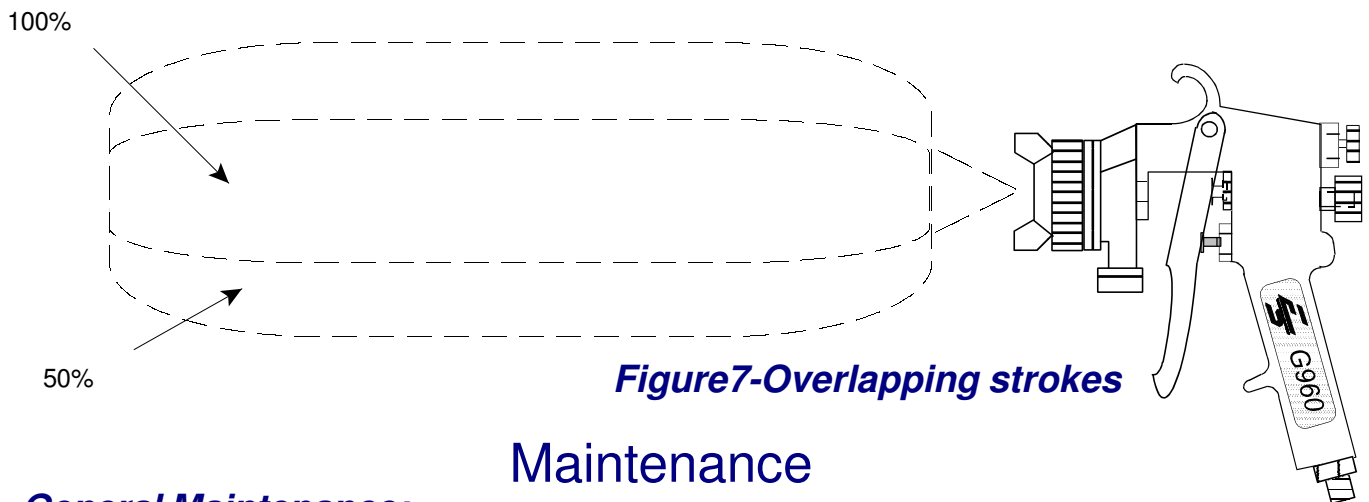

Figure 7-Overlapping strokes

Maintenance

General Maintenance:

Checking & Replacing the Needle

Needle wear is expected and inspection during cleaning will ensure the continued top performance of your Air Paint Sprayer. If needle tip wear is noted:

Step 1. Unscrew and remove the adjusting Screw

Step 2. Using a Pair of pliers or other suitable device, carefully pull and twist the Needle until it has been removed.

Step 3. Purchase an identical replacement Needle from ESMFG.

Step 4. By hand, carefully insert the Needle into the Housing and push until the tip has exited the hole in the NK Air Cap nozzle.

Step 5. Insert the Needle and insert it into the Housing.

Step 6. Replace the adjusting Screw and readjust its settings to the position it was in before removed (refer to Step 1).

Cleaning:

Warning: Always dispose of paints, coating and other chemicals in a proper and responsible fashion. If you have questions regarding the proper disposal of any chemical, contact the chemical manufacturer for instructions.

- Step 1. Depressurize the Cup (g960001) and disconnected the house.
- Step 2. Remove the Cover Assembly from the Cup as Described in OPERATION.
- Step 3. Empty the paint or coating from the Cup. Dipose of properly.
- Step 4. Pour a small amount of clean solvent (as Specified by the paint manufacturer) in the Cup. See Saftey Warnings and Caustions #5.
- Step 5. Place the Cover Assembly into the Cup and tighten until the assembly is sealed.
- Step 6. Reconnect the air hose to the Regulator and pressurize the cup.
- Step 7. Clean the Air Paint Sprayer by Shaking continuously and spraying the solvent though the gun.
- Step 8. Repeat steps 1 through 7 until the sprayed solvent appears clean and clear.
- Step 9. After depressurizing disconnect the regulator from the air supply.
- Step 10. Remove the Cover Assembly From the Cup and dispose of the surplus solvent.
- Step 11. Wipe the Cup clean with a dry, lint-free cloth.

Caution: For thorough cleaning, the CUP may be fully immersed in solvent. DO NOT LEAVE SOLVENT FOR MORE THAN 24HOURS as damage may occur. NEVER IMMERSSE THE AIR PAINT SPRAYER IN SOLVENT. When cleaning, brush solvent onto extiorior parts only.

Lubrication:

Before and after each use of a G960-2L, perform the following lubrication process, using a non-silicon, spray gun lubricant:

Step 1. Put 2 or 3 drops of lubricant on the Part of NK, in front of the Trigger(g960015). Tip the gun backward and allow the lubricant to drip into the front of the gun housing.

Step 2. Put 2 or 3 drops of lubricant on the Air Valve (g960024). Tip the gun backward and allow the lubricant to drip into the front of the gun housing.

Step 3. Put 2 or 3 drops of lubricant on the Fan Adjuster(g960014). Tip the gun backward and allow the lubricant to drip into the front of the gun housing.

Step 4. Put 1 drops of lubricant on the Trigger Stud (g960016) and another on the Trigger Screw (g960017). Work the Trigger to allow the lubricant to coat the parts.

Step 6. Put 1 drops of lubricant on the regulator Adjusting Cap(g960009). Tip it sideways and allow the lubricant to drip into the Air Cap.

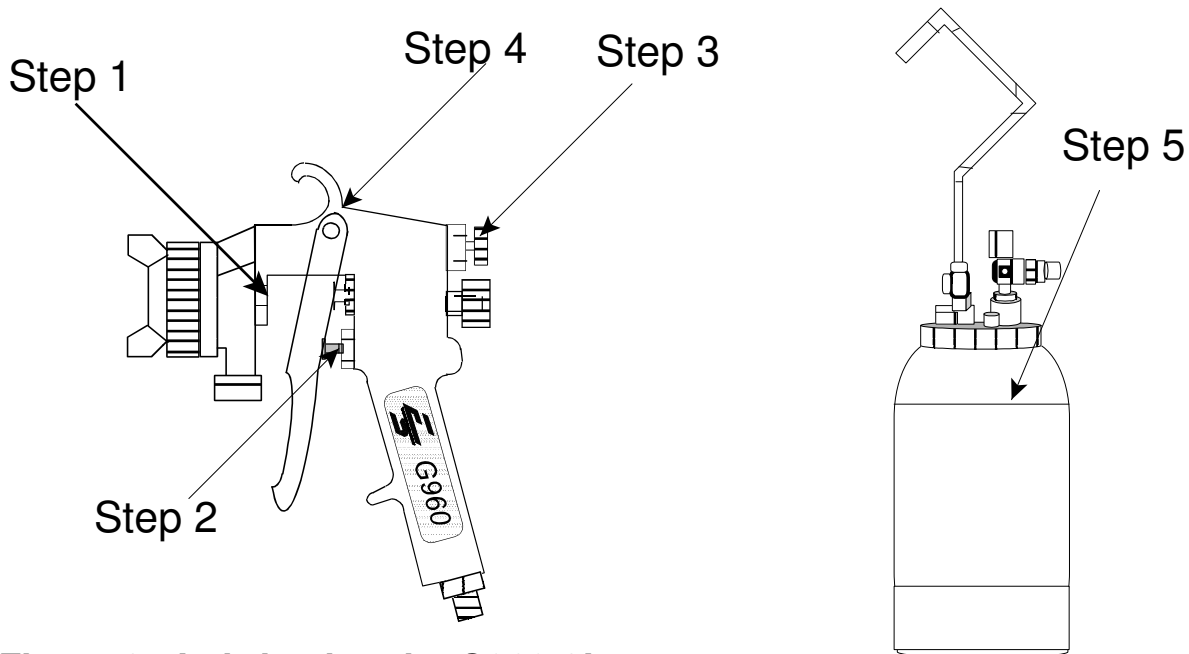

Figure 8 - Lubricating the G960-2L



ES Manufacturing, Incorporated

Est.
1973

Engineered Solutions

Makers of fine tools and accessories for the
fiberglass and composite industries

ES Manufacturing, Inc.
PO Box 11692
St. Petersburg, FL 33733-1692
USA



G9601L2.5



G9602L2.5



G9609L2.5

Fold Here

Date of Purchase ____/____/____

Your email address _____

Your Company's Name _____

Mailing Address _____

City / State / Postal Code _____

Phone # _____ Fax # _____

Web Site _____ Email _____

Primary Lines of Business _____

How many employees at this location 1-10 11-20 21-100 100 or more

Primary use for this Spray Gun (Circle one) Gelcoat Resin

If "Other" please describe: _____

Is this your first G960 Gun? Yes No

Is this your first ES Mfg. product? Yes No

Name of distributor this unit was purchased _____

What was your purchase price? _____

Did you purchase additional nozzles? Yes No

If so what size? _____

Which was more important to your purchase? Simplicity Effectiveness Price

Would you like us to send you a free catalog? Yes No

Comments _____

Important Notice: You should copy this sheet and keep it and your original sales receipt. Return this form with a copy of your sales invoice. Failing to return this form will void your warranty.

Note: Visit our website for duplicate copies of parts diagrams or instructions.