

ES MANUFACTURING, INCORPORATED

MADE IN U.S.A.

**ENGINEERED SOLUTIONS FOR
COMPOSITES MANUFACTURING**

MAKERS OF TOOLS AND ACCESSORIES FOR THE COMPOSITES INDUSTRIES

e-mail sales@esmfg.com US/Canada 800-55ES-MFG

2647 24th St. NO. ST. PETERSBURG, FL 33713 727-323-4040 FX 727-327-9872



Documentation & Warranty Packet

MB110 (600 rpm's)

Thank you for purchasing the **MB110** If properly operated and maintained, this Heavy Duty Fiber Cutter will provide years of trouble free service.

WARRANTY

This model **MB110** is warranted against defects for a period of 90 days. Keep your original sales receipt for proof of purchase. ES Mfg., Inc. will replace or repair any defective part, either directly, or through the distributor, at the option of ES Mfg. Warranty shall not cover mis-use or damaged caused by the user. ES Mfg. Reserves the right to inspect the merchandise at our facility, and is not responsible for transportation cost to ES Mfg. ES Mfg. Is not responsible for damage, loss, lost production or any other expenses due to the failure of this product. No other warranty is expressed or implied.

Copyright 2007 ®
ES Manufacturing, Inc.
2647 24th Street North
St. Petersburg, FL 33713

US / Canada: 800-55ES-MFG Local / International: 727-323-4040 Fax: 727-327-9872

OPERATING INSTRUCTIONS, MAINTENANCE & SAFETY

MB110-115V

600 rpms



Cutters are precision tools made by master craftsman.

In order to maintain this precision and the adjustments which are essential to satisfactory operation of your cutter, it is important to conscientiously follow these instructions.

1. In General

Handle cutter with great care. Do not drop it or handle it roughly as this will change its adjustments and may cause serious damage mechanism.

2. Prior to Starting the Cutting Operation

Firstly set the "ON/OFF" switch to the "off" position, connect the female plug of the electric cord with the machine terminal and then tighten the screw on the female lug. Now connect the male plug of the electric cord to the electrical outlet. Prior to starting the cutting operation remove any obstacle from the path of the base plate.

3. Cutting Operation

Do not force cutter through material. By nature of their texture and because of the properties of their fibers, not all materials can be cut with the same speed or ease. Trail cutting will readily let you find the best speed at which the machine is to be advanced through the material.

4. Sharpening the Blade

1. Connect the plug of the electric cord to the Power supply.
2. Push the switch to start the machine.
3. Pressing the Push Knob (#21) down for a few seconds so that the sharpening stone lightly touches and grinds the blade several times.

5. How to replace Blade

1. Make sure the electrical cord is disconnected from power source.
2. Turn the screw for finger guard (#4) and remove finger guard (#5).
3. Remove the blade lock nut (#1) by turning it (#61,28,29,30).
4. Remove blade (#27) clean and dust or dirt from machine.
5. Replace dirt blade.

6. How to Replace Carbon Brush

1. While the machine is unplugged. Remove the two screw (#57) & pull the cover (#54) upward.
2. Remove the screw cap (#49) Over the carbon brush and replace the carbon brush (#50-1).
3. Put the cover (#54) back into its original position and tighten the screw.
4. Check the right and left carbon brushes from time to time and always replace both right and left carbon brushes when worn out.

7. Lubrication and Maintenance

1. Turn the grease cup (#7) clockwise a little bit to inject the grease into gear box.
2. Make sure to add grease supplied with the machine to the grease cup (#6) when the grease cup is screwed down to clean the bottom.
3. Always keep the machine clean and free from remnants.

8. Maintenance and Inspection

1. Keep machine clean by removing all accumulations of lint, thread and cuttings from around the knife itself to clean away from behind it, any accumulated matter.
2. In addition, add grease to the grease cup monthly using the special grease the is supplied with the machine.
3. From time to time, check the right and left carbon brushes and replace when necessary.
4. It is recommended that the machine be turned off when not in use.
5. Never put your hands in front of the blade when operating.
6. Before doing any work on the machine, be sure to disconnect the machine from the electrical outlet.

ES Manufacturing, Incorporated

Est.
1973

Engineered Solutions



Makers of fine tools and accessories for the fiberglass and composite industries

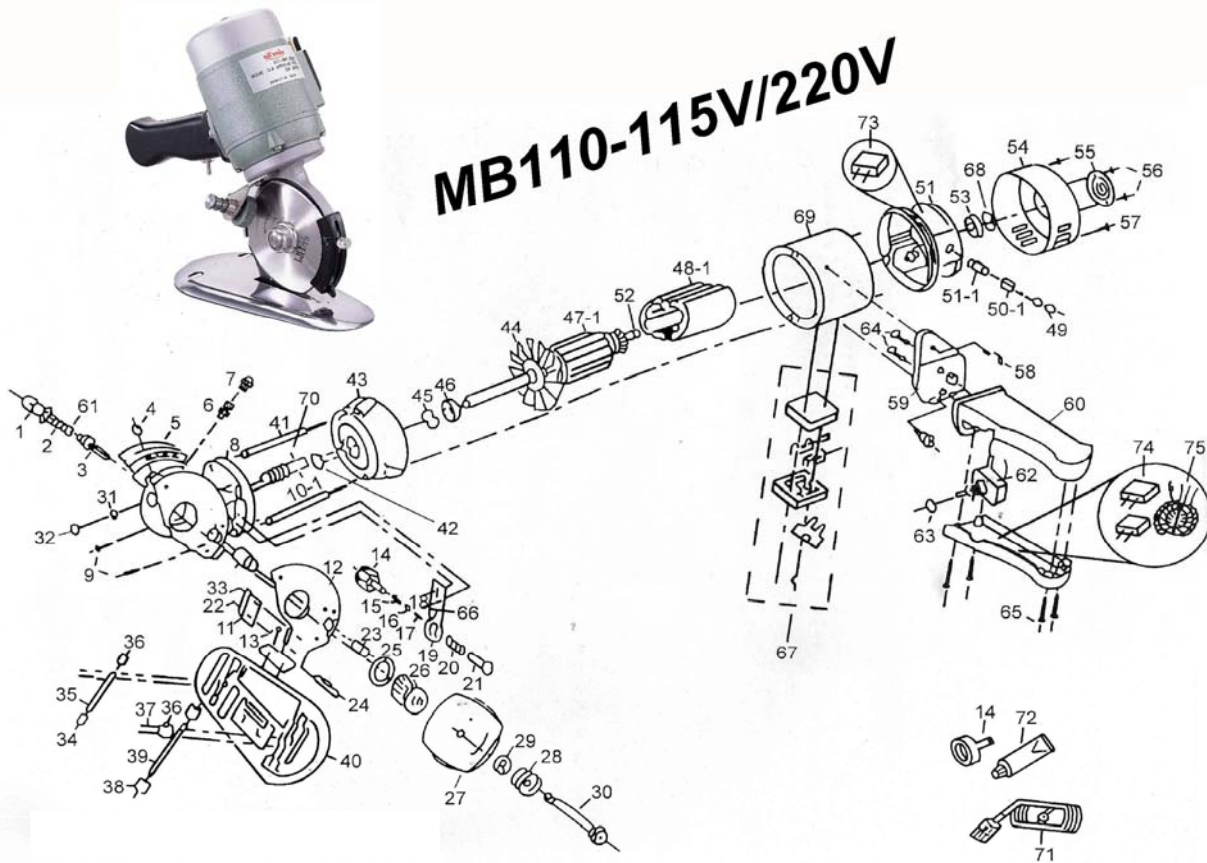

MB110-001	Adjusting Nut For Blade	MB110-025	Worm Gear Washer	MB110-049	Cab for Carbon Brush
MB110-002	Spring	MB110-026	Worm Gear	MB110-050-ASSY	Carbon Brush w/Spring
MB110-003	Shaft for Gear	MB110-027	Blade	MB110-051	Motor Cover
MB110-004	Screw For Finger Guard	MB110-028	Lock cover for Blade	MB100-052	Snap Ring (E7)
MB110-005	Finger Guard	MB110-029	Bearing	MB100-053	Bearing
MB110-006	Grease Cup	MB110-030	Srew for Blade	MB100-054	End Cover
MB110-007	Cap for Grease Cup	MB110-031	Bearing	MB110-055	Cap for Cover
MB110-008	Gear Box	MB110-032	Cap for Bearing	MB110-056	Screw
MB110-009	Screw	MB110-033	Oil Felt Tube	MB110-057	Screw
MB110-010-1	Worm Gear	MB110-034	Rollers	MB110-058	Screw
MB110-011	Guide Plate	MB110-035	Rollers Shaft	MB110-059	Handle Fixed Base
MB110-012	Gear Box Fixed Base	MB110-036	Rollers Shaft Fix. Plate	MB110-060	Handle
MB110-013	Screw	MB110-037	Screw	MB110-061	Nut For Switch
MB110-014	Sharpening Stone	MB110-038	Rollers	MB110-062	Switch
MB110-014-ASSY	Sharpening Stone Ass'y	MB110-039	Roller Shaft	MB110-063	Nut For Switch
MB110-015	Lock Nut for Stone	MB110-040	Base Plate	MB110-064	Screw
MB110-016	Snap Ring (E3)	MB110-041	Screw	MB110-065	Screw
MB110-017	Spring	MB110-042	Retaining Ring	MB110-066	Screw
MB110-018	Screw	MB110-043	Front Cover	MB110-067	Plug
MB110-019	Sharpening Stone Bracket	MB110-044	Snap Ring	MB110-068	Wave Washer
MB110-020	Spring	MB110-045	Wave Washer	MB110-069	Motor Cover
MB110-021	Push Knob For Stone	MB110-046	Beariing	MB110-070	Screw For Worm Gear
MB110-022	Screw	MB110-047-1	Rotor	MB110-071	Cord complete w/Earch
MB110-023	Oil Felt	MB110-048-1	Stator	MB110-072	Grease
MB110-024	Counter Blade				



Supplemental instructions for MB110 Fiber Mat Cutters

Thank you for purchasing our MB110 Heavy Duty Cutter for your fiberglass cutting needs. This tool will give you years of service provided you maintain and care for the tool properly. Our experience in the composite industry allows us to supplement the instructions supplied by the manufacturer.

1. Inspect daily the concentricity and condition of the blade. The alignment of the rotating blade to the carbide counter blade is crucial to the operation of this tool. Hard items, such as cured composites will damage the blade, the counter blade, drive gears and possibly the motor. This is a heavy duty textile cutter and is not meant for cured composites or other hard materials.
2. On or before 150 hours of usage, replace the MB110-050-ASSY. We have supplied this assembly with your new purchase. This is common with all small motors. If not changed in a timely, regular manner, critical damage will occur to the rotor section of the motor. This damage can be fatal and expensive to repair. Usually to cost of the repair is higher than the cost of a new unit.
3. When replacing the blade, be sure that all surfaces are completely clean. Just the slightest contamination, especially under the blade will cause damage to the arbors, blade and counter blade of this unit.
4. Never modify the cord of this unit. It is designed for the correct amperage drawn from the motor. Any modification of this cord will not only void the warranty, but create a significant risk of fire or explosion.
5. Use the self sharpening device included with your cutter only when necessary. This should be used sparingly, as overuse will cause excessive wear to the blade.
6. Be sure to lubricate your MB110 daily or every 2 hours of operation, whichever is greater.



MB110



Please take a few Minutes to fill out the below warranty sheet. It will help us serve you better.

ES MANUFACTURING, INC.
PO BOX 11692
ST. PETERSBURG, FL 33733- 1692 USA

Thomas D. Elder
President, ES Manufacturing, Inc.

FOLD HERE

If you have pictures of the products you make, we would like to display them at our domestic and international trade shows.

Date of Purchase: _____

Company Name: _____

Street Address: _____

City / State / Zip: _____

Phone#: _____ Fax #: _____

Contact: _____

Primary Line of Business: _____

Is this your first ES Mfg., Inc. purchase? Yes No

Who did you purchase this unit from?: _____

What was your purchase price?: _____

Which was more important in your purchase?:

Simplicity Effectiveness Price Reputation

Would you like a free catalog?: Yes No

Comments: _____

Please return this sheet in the enclosed envelope.